

## Cornwallis Gardens, Hastings TN34 1LP

Offers in excess of £210,000



A bright and spacious TWO BEDROOM APARTMENT spanning the GROUND FLOOR of this attractive PERIOD RESIDENCE situated in a CENTRAL LOCATION. It's ideally placed adjacent to Cornwallis Gardens and just a short stroll from the beach, Hastings mainline railway station and a range of shops at Priory Meadow. The accommodation here enjoys GENEROUS PROPORTIONS and is arranged as a bright, OPEN PLAN KITCHEN AND LIVING SPACE offering plenty of room for a full dining table along with an original feature fireplace and a bay fronted window which frames a leafy view across Cornwallis Gardens. There are TWO DOUBLE BEDROOMS positioned at the rear of the property together with a family bathroom and separate w/c. Being sold with a SHARE OF FREEHOLD this fantastic property would make the PERFECT FIRST TIME HOME or seaside retreat and is not to be missed.

GROUND FLOOR  
761 sq.ft. (70.7 sq.m.) approx.

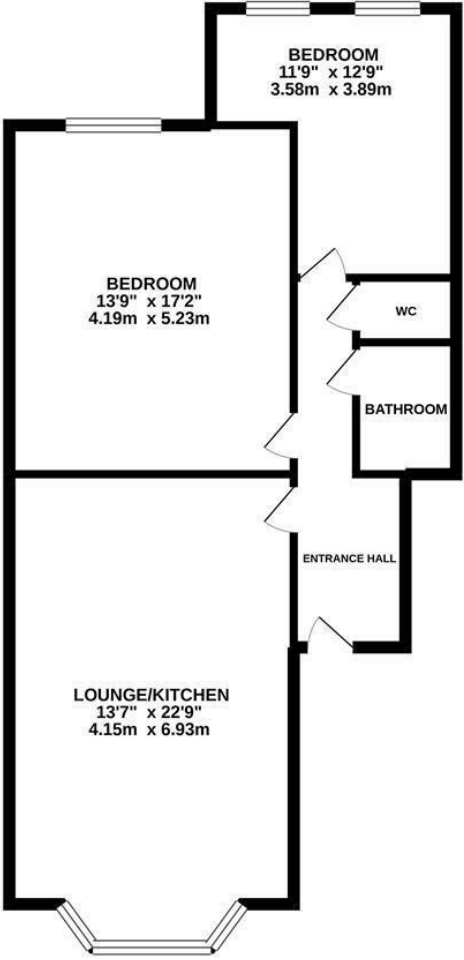

TOTAL FLOOR AREA: 761 sq.ft. (70.7 sq.m.) approx.

Whilst every attempt has been made to ensure the accuracy of the floorplan contained here, measurements of doors, windows, rooms and any other items are approximate and no responsibility is taken for any error, omission or mis-statement. This plan is for illustrative purposes only and should be used as such by any prospective purchaser. The services, systems and appliances shown have not been tested and no guarantee as to their operability or efficiency can be given.  
Made with Metropix ©2021

